



69 Bayview Ridge



Country Living in the City! Don't miss this once-in-a-lifetime property overlooking the Rosedale Golf Club. In one of Toronto's most prestigious neighbourhoods and tucked away on a quiet street, 69 Bayview Ridge is a gorgeous Tudor-style home on an expansive private estate. Unlike any property you have seen.

Spanning nearly an acre and a half of meticulously manicured tree-lined land, this five-bedroom, four-bathroom home exudes elegance and sophistication, allowing the opportunity for a tasteful renovation project while preserving the old-world charm displayed in the current residence or a blank canvas to build the home of your dreams featuring beautiful golf course views from a stately hilltop. As the only plot of land in the Bridle Path community offering clear views and the ability to build on over an acre of land, this is truly an opportunity to create one of the city's most extraordinary homes.



The property currently features an elegant circular driveway with a double-car garage, charming, old-world finishes throughout, generous principal rooms, a delightful kitchen with a spacious breakfast area, formal dining and living rooms overlooking a beautiful backyard and golf course, a second-floor family room, exceptionally sized bedrooms, and a finished lower-level recreation room. This home offers endless space and possibilities. Walk out to your backyard oasis, where beyond a large outdoor space and an abundance of greenery, you will find a view like no other.

Excellent school districts and minutes to Highway 401, Don Valley Parkway, public transit, Rosedale Golf Club, Granite Club, shops, restaurants, and much more.



69 BAYVIEW RIDGE



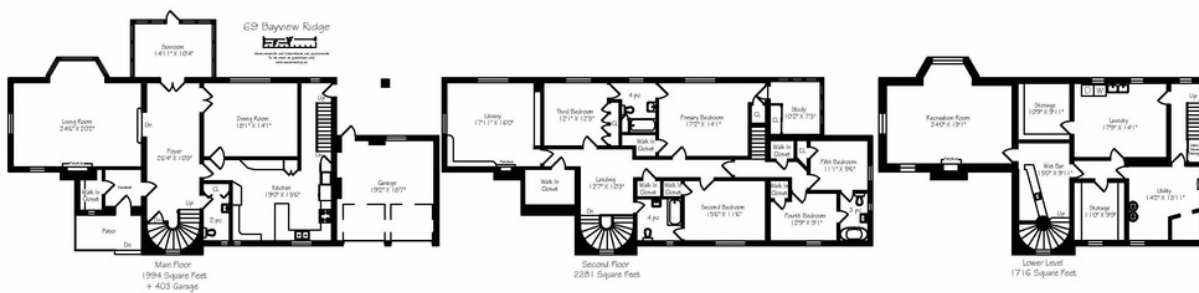

Details

TAXES

\$2,384.53 (monthly)

TAXES

\$27,863.57 (2023)

POSSESSION

30/60 Days(TBD)

HEATING

Hot Water Gas

COOLING

Central Air Conditioning

PARKING & LOCKER

Endless parking is available in the circular driveway and double attached garage.

Features

- Expansive estate spanning nearly an acre and a half of land in one of Toronto's most desirable neighbourhoods.
- This is one of three properties in the Bridle Path neighbourhood, offering unobstructed, breathtaking hilltop views overlooking Rosedale Golf and Country Club.
- Tudor style five-bedroom, four-bathroom home, exuding elegance and sophistication throughout over 5,000 square feet of living space.
- Charming, old-world finishes, generous principal rooms, and a delightful kitchen with a spacious breakfast area.
- Formal dining and living rooms overlooking a beautiful backyard and gorgeous greenery.
- Exceptional-sized bedrooms, all offering ensuite baths.
- Elegant circular driveway leading to a double car garage.
- The perfect opportunity to design and build the home of your dreams or reimagine the existing house and all it has to offer
- Backyard oasis with unrivalled views.
- Upper-scale living amongst the city's most influential business people and celebrities.
- Excellent school districts are within minutes of Highway 401, Don Valley Parkway, and public transit.
- Local private clubs include Rosedale Golf and the Granite Club





INCLUSIONS

- Fridge
 - Stove
 - Dishwasher
 - Washer
 - Dryer
 - All existing light fixtures
 - All existing window coverings
- (All inclusions in “as is” condition)

EXCLUSIONS

- Chandelier in foyer
- Chandelier in kitchen
- Chandelier in dining room



HEAPS ESTRIN

REAL ESTATE TEAM

We are a team of passionate and dedicated professionals who strive to ensure that each client's unique needs are met. Our goal is to deliver every client with a full service real estate experience that exceeds all expectations.



CAILEY HEAPS
BROKER OF RECORD

416.424.4910
cailey@heapsestrin.com



SCOTT VASILIOU
REAL ESTATE AGENT

416.424.4910
scott@heapsestrin.com



Follow us to learn more about our
exclusive listings, events and contests.

HEAPSESTRIN.COM | 416.424.4910 | @HEAPSESTRIN

For Royal LePage Real Estate Services Heaps Estrin Team, Brokerage. All information and statements contained herein, provided by Royal LePage Real Estate Services Heaps Estrin Team, Brokerage regarding property for sale, rental or financing is from sources deemed reliable and assumed correct, but no warranty or representation is made as to the accuracy thereof and same is submitted subject to errors, omissions, changes in price, rental or other conditions, prior sale or withdrawal without notice.

Royal LePage Real Estate Services Heaps Estrin Team, Brokerage Independently Owned and Operated